



POLYFILM

From the datasheet collection at <http://www.polyfilmambalaj.com>



Polyfilm Polyplex Polyester Films

Type: MW100 (milky white PET) 125my

Polyfilm Milky White MW100 grade Polyester film specially developed as an insulating material for rotating electrical motors, exhibits superior thermal ageing performance compared to normal polyester films. It has excellent slip and dimensional stability over a wide range of temperatures.

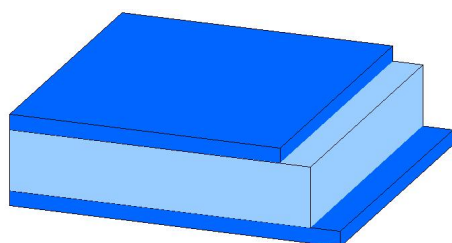
Composition



-  standard surface
-  core layer
-  standard surface

Typical Properties

Provisional data

Property	Units	Nominal	Method	Conditions
Mechanical Properties				
Nominal thickness	μ	125	Polyplex Method	
Unit weight	g/m ²	175		
Yield	m ² /kg	5.71	Polyplex method	
Elongation at break	MD %	120	ASTM D-882	
	TD %	110		
Tensile strength	MD kg/cm ²	1800	ASTM D-882	
	TD kg/cm ²	1900		
Thermal Properties				
Heat shrinkage	MD %	1.4	ASTM D-1204	150 Deg. C/30 min.
	TD %	0.4		

Property	Units	Nominal	Method	Conditions
Surface Properties				
Co-efficient of friction (A/B) static		0.44	ASTM D-1894	
Co-efficient of friction (A/B) dynamic		0.40	ASTM D-1894	
Optical Properties				
Haze	%	80.0	ASTM D-1003	
Electrical Properties				
Break down voltage	KV	18.0	ASTM D-149	
Surface resistivity	Ohm	10 ¹²	ASTM D-149	
Volume resistivity	Ohm cm	10 ¹⁶	ASTM D-149	

Disclaimer

The information given above is to the best of our knowledge and experience at the time of printing. We make no warranty, express or implied, for specific product properties or as to the fitness of the product for any specific use or purpose. The above data is purely for reader's consideration, investigation and verification and should be read in conjunction with the general conditions for sale.

Edition: 11/2013