



## Polyfilm Polyplex Polyester Films

### Type: DL100 matte PET film 36my

Polyfilm DL grade Polyester film is specially designed as base film for packaging and industrial applications. This translucent film is a co extruded film and has one side matt appearance with low gloss and other side standard PET surface with normal gloss.

### Composition

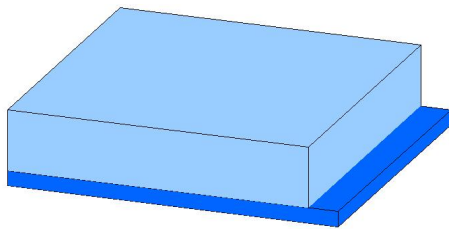

- core
- matte surface
- standard surface

### treatment

DL100 = one side normal matt and other side plain (matt wound inside)

### Typical Properties

Provisional data

Property	Units	Nominal	Method	Conditions
Mechanical Properties				
Nominal thickness	$\mu$	36	Polyplex Method	
Yield	$m^2/kg$	19.9	Polypex Method	
Unit weight	$g/m^2$	50.4		
Density	$g/cm^3$	1.4		
Elongation at break	MD %	140	ASTM D-882	
	TD %	130		
Tensile strength	MD $kg/cm^2$	2000	ASTM D-882	
	TD $kg/cm^2$	2100		

Property	Units		Nominal	Method	Conditions
<b>Thermal Properties</b>					
Heat shrinkage	MD	%	1.6	ASTM D-1204	150 Deg. C/15 minutes
	TD	%	0.2		
<b>Surface Properties</b>					
Co-efficient of friction static			0.50	ASTM D-1894	
Co-efficient of friction dynamic			0.45	ASTM D-1894	
<b>Optical Properties</b>					
Haze		%	35	ASTM D-1003	
<b>Barrier Properties</b>					
Gloss at 60 deg matt surface			45	ASTM D-2457	

## Standard Roll Presentation

Thickness	Core	Length	outside diameter
μ	mm	m	mm
36	76	3000	400
36	76	4500	480
36	152	8000	650

## Disclaimer

The information given above is to the best of our knowledge and experience at the time of printing. We make no warranty, express or implied, for specific product properties or as to the fitness of the product for any specific use or purpose. The above data is purely for reader's consideration, investigation and verification and should be read in conjunction with the general conditions for sale.

Edition: 8/2008